

Instructions

1. Use tape to temporarily position the Stone Guard MX™ onto your trailer.
2. The bottom edge of the Stone Guard MX™ sits inside your trailer's trim.
3. You may need to cut around your trailer's tongue if your trailer is "tongue thru frame" style (as shown in the photo alongside).
4. Use 3/16" aluminum pop rivets to attach. If your trailer has wood studs, use wood screws to attach. You may also use sheet metal screws to attach.
5. Pre-drill holes every 6" along the top edge.
6. Pre-drill holes every 4" along the vertical edges.
7. Pre-drill holes every 12" along the bottom edge.
8. Install fasteners starting from middle of the Stone Guard MX™ and work outward.



Helpful Hint!

Remove protective plastic film before installation



Trailer Stone Guard MX™
P/N: HTSG

Any questions or problems, please contact us:

diamondLife
234 Lott Road
Pittsburgh, PA 15235
USA

Ph. 1.888.98.DGEAR (983.4327)
Email. help@diamondlifegear.com
Store. diamondlifegear.com

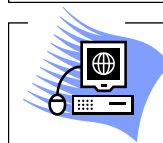

Find hundreds of more great work space enhancement products at www.diamondlifegear.com

Doing a common thing uncommonly well, brings success.

Welcome to the diamondLife.™

Fastening using pop rivets

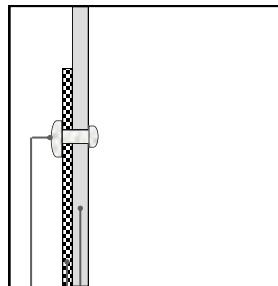

Trailer wall
Trailer Stone Guard MX™
3/16" aluminum pop rivet

Fastening using sheet metal screws

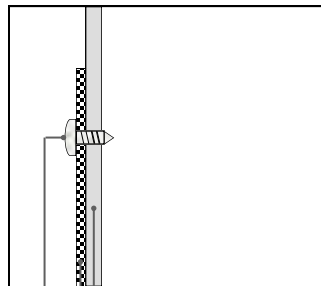

Trailer wall
Trailer Stone Guard MX™
3/16" sheet metal screw

Fastening into wood stud

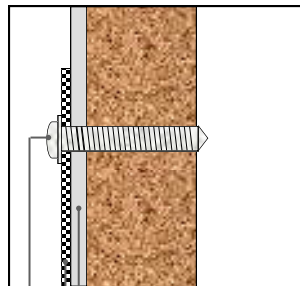

Trailer wall
Trailer Stone Guard MX™
3/16" dia x 2"L wood screw

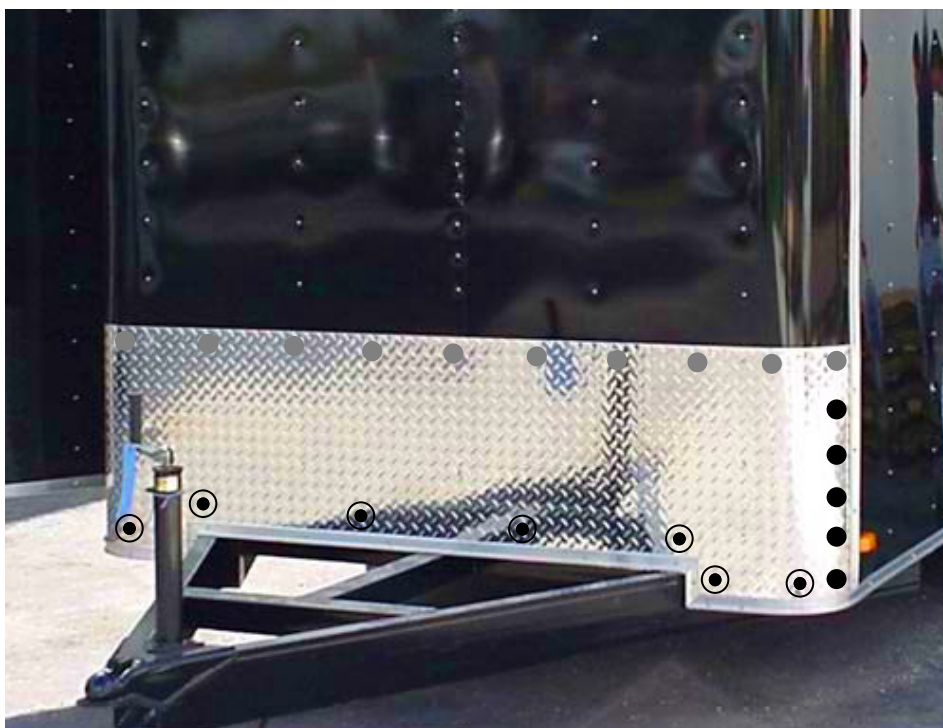

Helpful Video
Point camera at QR code



 diamondLife