

Instructions

Contents



Power drill and hook not included

SlatWall MX™
P/N: HSL

Doing a common thing uncommonly well, brings success.

Welcome to the diamondLife.™

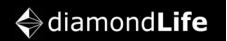

Installation Instructions

When unpacking your SlatWall MX™, it is normal to see fraying around the grooves. This fraying is the protective plastic film that is on the surface of your slatwall to protect it during manufacturing and transit. The fraying naturally occurs when the grooves are cut into the slatwall. Remember to remove the protective plastic film from the slatwall after installation.

Mounting into structural wall components (ie wall studs)

1. Fasten onto wall using slat wall channels for mounting.
2. For SlatWall with decorative Channel Strips, slide out Channel Strips. For SlatWall with Extruded Aluminum Channel Reinforcements, DO NOT slide them out. Your screws need to go thru the Extruded Aluminum Channel Reinforcements, thru the SlatWall, then into your wall.
3. Pre-drill holes into **SlatWall MX™** channels to locate panel onto structural wall components (ie wall studs) wherever possible. Use a level to ensure level horizontal mounting.
4. Use as many wall studs as possible.
5. Pre-drilled holes should be located vertically every 12"-16" (appx every 4th slat).
6. Countersink all pre-drilled holes so screw heads do not protrude into channel. Screw heads protruding into channel may inhibit movement of hooks.
7. If mounting multiple panels, mount bottom panel first. Panels have a projecting lip which allows panels to be fitted into one another.
8. Using proper size fastener, screw panel into wall.
9. Do not over tighten screws.

Mounting into hollow wall

1. Fasten onto hollow wall using slat wall channels for mounting.
2. Position panel onto wall. Use a level to ensure level horizontal mounting.
3. Drill holes thru **SlatWall MX™** channels and into hollow wall. Holes should be located appx 16" on centers—therefore vertically every 4th slat appx.
4. Remove panel from wall.
5. Install hollow wall anchors into wall.
6. Locate panel onto wall and install screws into anchors.

Any questions or problems, please contact us:

diamondLife
234 Lott Road
Pittsburgh, PA 15235
USA

Ph. 1.888.98.DGEAR (983.4327)
Email. help@diamondlifegear.com
Store. diamondlifegear.com



Helpful Hint!

Remove the protective plastic film from the slatwall after installation.

CAUTION!

Keep heavy loads at least 3 inches away from either ends of SlatWall MX™ Panel. Hanging heavy loads close to the ends can cause the panel to break. Also keep any heavy loads hung on the same slat at least 6 inches apart.

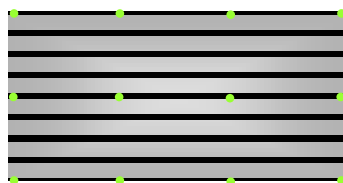

2'x4' panel

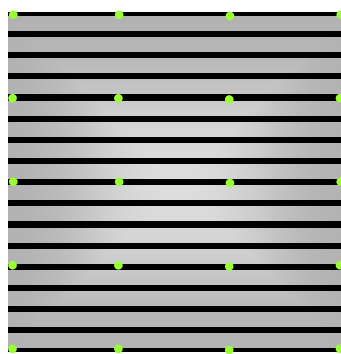

4'x4' panel

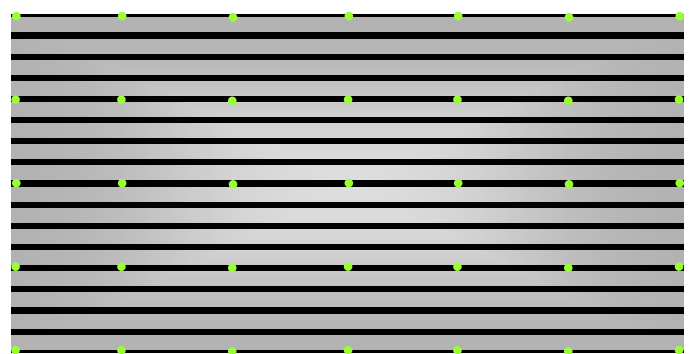

4'x8' panel

Fastening into wall stud

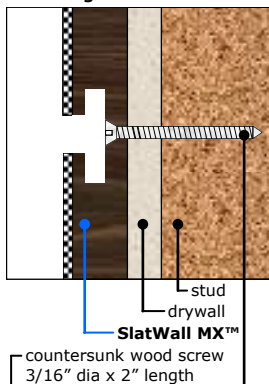

Fastening into hollow wall

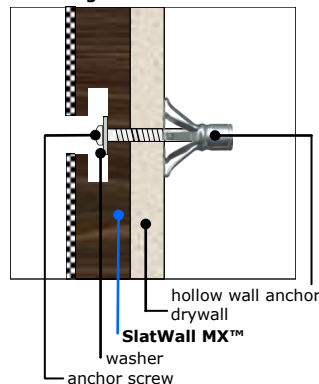

Fastening into masonry wall

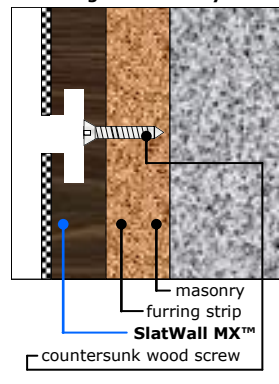

Accessories



Peg Hooks



Baskets



Bins



Organizers



Mounting Fasteners



End Caps