

# Instructions

## Contents



SlatWall MX™ Strip



Guitar Hanger



Guitar Hanger MX™

## Installation Instructions

**Guitars are precious things! Please be sure to follow the installation instructions below so your guitars hang safely and securely for years.**

- 1. Fasten onto wall using slat wall channels for mounting
2. Pre-drill 5/32"Ø holes into **SlatWall MX™ Strip** channels thru the aluminum channel inserts to locate panel onto structural wall components (ie wall studs) wherever possible.
3. **IMPORTANT! Screws must be installed through the aluminum channel inserts to ensure highest load capacity strength. Failure to do so may cause the unit to break.**
4. Use as many wall studs as possible
- 5. **IMPORTANT! Position screws at both ends of the SlatWall MX™ Strip . If there is no stud at these locations, use appropriate wall anchors. Failure to do so may cause the unit to break.**
6. Pre-drilled holes should be located every 12"-16"
7. Depending on the size of your screw heads, countersinking the pre-drilled holes may be necessary so the screw heads protruding into the channel do not inhibit movement of hooks.
8. Use a level to ensure level horizontal mounting
9. Using proper size fastener, screw panel into wall
10. Do not over tighten screws
  - Due to the manufacturing process, a slight bow in the SlatWall MX™ Strip is normal. This bow is naturally removed by the installation process.
  - **Helpful Hint:** if you are hanging Guitars and want to permanently position the hanger, use a thick double sided foam tape on the backside of the hanger



48" strip shown



96" strip shown

Any questions or problems, please contact us:

Gupta Permold Corporation  
Consumer Goods Division  
diamondLife™ Brand  
234 Lott Road  
Pittsburgh, PA 15235  
USA  
Ph. 412.793.3511 x103  
Fx. 412.793.1055  
Email. help@diamondlifegear.com  
Store. diamondlifegear.com



Find hundreds of more great work space enhancement products at [www.diamondlifegear.com](http://www.diamondlifegear.com)

Doing a common thing uncommonly well, brings success.

Welcome to the diamondLife.™



### Helpful Hint!

Remove protective plastic film after installation

## Accessories



Heg Hooks



Baskets



Bins



Organizers



Mounting Fasteners

### Fastening into wall stud

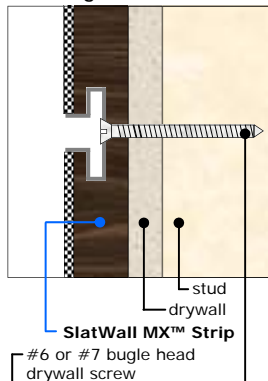

### Fastening into hollow wall

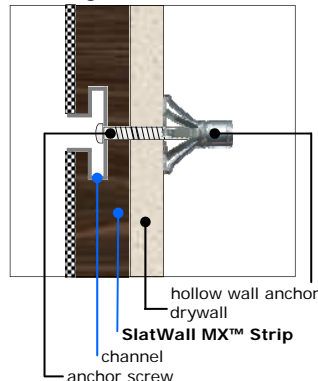

### Fastening into masonry wall

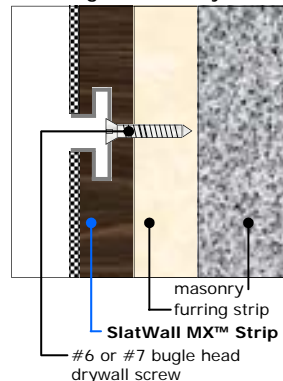

## CAUTION!

Keep guitars at least 3 inches away from either ends of SlatWall MX™ Strip. Hanging heavy loads close to the ends can cause the product to break. Also keep guitars at least 6 inches apart.