

Instructions

Contents



Power drill and hook not included

SlatWall MXi™
P/N: HSLi4896
HSLi4848
HSLi2448

Installation Instructions

Mounting into structural wall components (ie wall studs)

1. Fasten onto wall using slat wall channels for mounting
2. For items with Channel Strips, slide out Channel Strip
3. Pre-drill holes into **SlatWall MXi™** channels to locate panel onto structural wall components (ie wall studs) wherever possible. Use a level to ensure level horizontal mounting
4. Use as many wall studs as possible
5. Pre-drilled holes should be located vertically every 12"-16" (appx every 4th slat)
6. Countersink all pre-drilled holes so screw heads do not protrude into channel. Screw heads protruding into channel may inhibit movement of hooks.
7. If mounting multiple panels, mount bottom panel first. Panels have a projecting lip which allows panels to be fitted into one another
8. Using proper size fastener, screw panel into wall
9. Do not over tighten screws.
10. For items with Black Channels, slide Black Channel Strip in to hide fasteners

Mounting into hollow wall

1. Fasten onto hollow wall using slats (not channels) for mounting
2. Position panel onto wall. Use a level to ensure level horizontal mounting
3. Drill holes thru panel's slats and into hollow wall. Holes should be located appx 16" on centers—therefore vertically every 4th slat appx
4. Remove panel from wall
5. Install hollow wall anchors into wall
6. Locate panel onto wall and install screws into anchors
 - Due to the manufacturing process, a slight bow in the SlatWall MXi™ panel is normal. This bow is naturally removed by the installation process.

Any questions or problems, please contact us:

Gupta Permold Corporation
Consumer Goods Division
diamondLife™ Brand
234 Lott Road
Pittsburgh, PA 15235
USA
Ph. 412.793.3511 x103
Fx. 412.793.1055
Email. help@diamondlifegear.com
Store. diamondlifegear.com



Helpful Hint!

Remove protective plastic film from metal fascia after installation.

CAUTION!

Keep heavy loads at least 3 inches away from either ends of SlatWall MXi™ Panel. Hanging heavy loads close to the ends can cause the panel to break. Also keep any heavy loads hung on the same slat at least 6 inches apart.

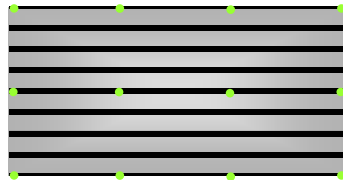

2'x4' panel

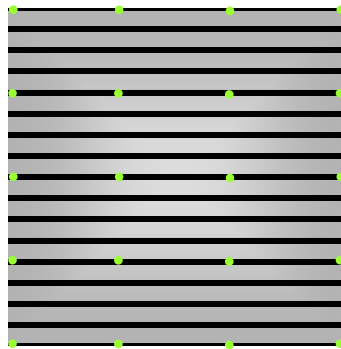

4'x4' panel

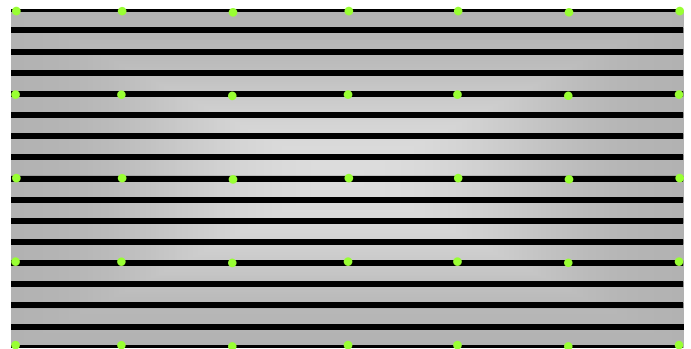

4'x8' panel

Fastening into wall stud

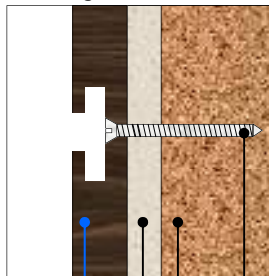

stud
drywall
SlatWall MXi™
countersunk wood screw
3/16" dia x 2" length

Fastening into hollow wall

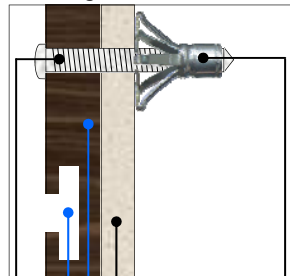

hollow wall anchor
drywall
SlatWall MXi™
channel
anchor screw

Fastening into masonry wall

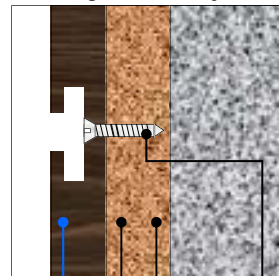

masonry
furring strip
SlatWall MXi™
countersunk wood screw

Accessories

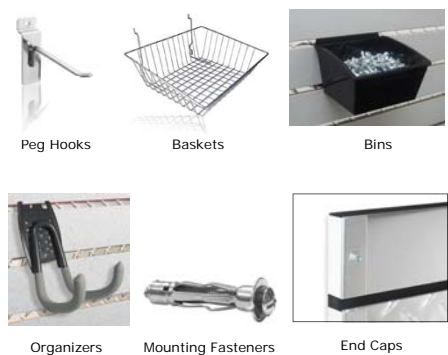

Peg Hooks

Baskets

Bins

Organizers

Mounting Fasteners

End Caps